

TECHNICAL DATA SHEET PHOENIX P50 ATEX



PP+CF



PVDF+CF



ALU



AISI 316

TECHNICAL DATA P50 ATEX

- FLUID CONNECTIONS : 1/2" BSP
- AIR CONNECTION : 1/4" BSP
- MAX FLOW RATE : 55 lt/min
- MAX AIR PRESSURE: 8 bar
- MAX DELIVERY HEAD: 80 m
- MAX SUCTION LIFT DRY: 6 m
- MAX SUCTION LIFT WET: 9,8 m
- MAX SOLID PASSING: 3,5 mm
- NOISE LEVEL: 68 dB
- DISPLACEMENT FOR CYCLE: 85 cc
- MAX VISCOSITY : 20.000 cps
- ATEX zone 1 : EX II 2/2 GD c IIB T135°C

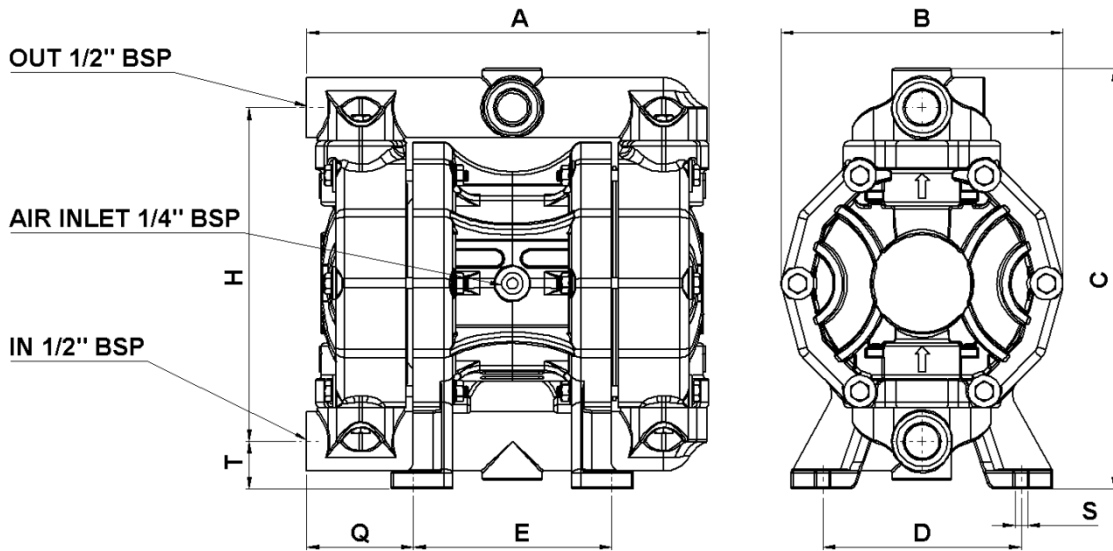
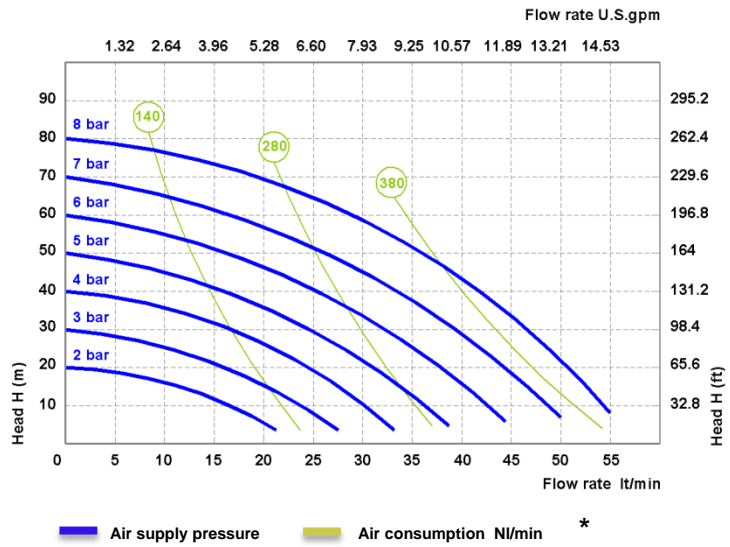

PHOENIX P50	A	B	C	D	E	H	Q	S	T	Weight Kg	Max Temperature
PP+CF	222	153	233	110	110	185	59	7	27	4	65 °C
PVDF+CF	222	153	233	110	110	185	59	7	27	4,5	95°C
ALU	225	156	230	110	110	183	59	7	26	5	95 °C
AISI 316	225	156	230	110	110	183	59	7	26	6	95°C

* The curves and performance values refer to pumps with submerged suction and a free delivery outlet with water at 20°C, and vary according to the construction material. Technical data are approximate and not binding for the manufacturer who reserves the right to change them without notice at any time.

COMPOSITION

MODEL	CASING	DIAPHRAGM	BALL	SEATS	GASKET	CONNECTIONS	ATEX	PORTS IN/OUT
P0050	PC= PP+CF KC= PVDF+CF A= ALU S=SS	HT=HYTRE+PTFE MT=SANTOPRENE+PTFE H=HYTREL N=NBR	T= PTFE S= SS D=EPDM N=NBR	P=PP K=PVDF A=ALU S=SS Z=PE-UHMWE	D=EPDM V=VITON N=NBR T=PTFE	1=BSP 2=FLANGED 5=NPT	X = zone 1	AB=Standard

AVAILABLE CONNECTIONS

Standard = A B
IN = A-E-T-C-G
OUT =B-S-D-F-P

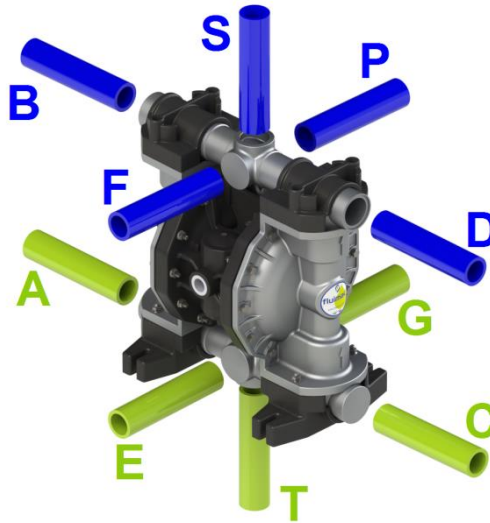

HOW TO READ THE CODE

